

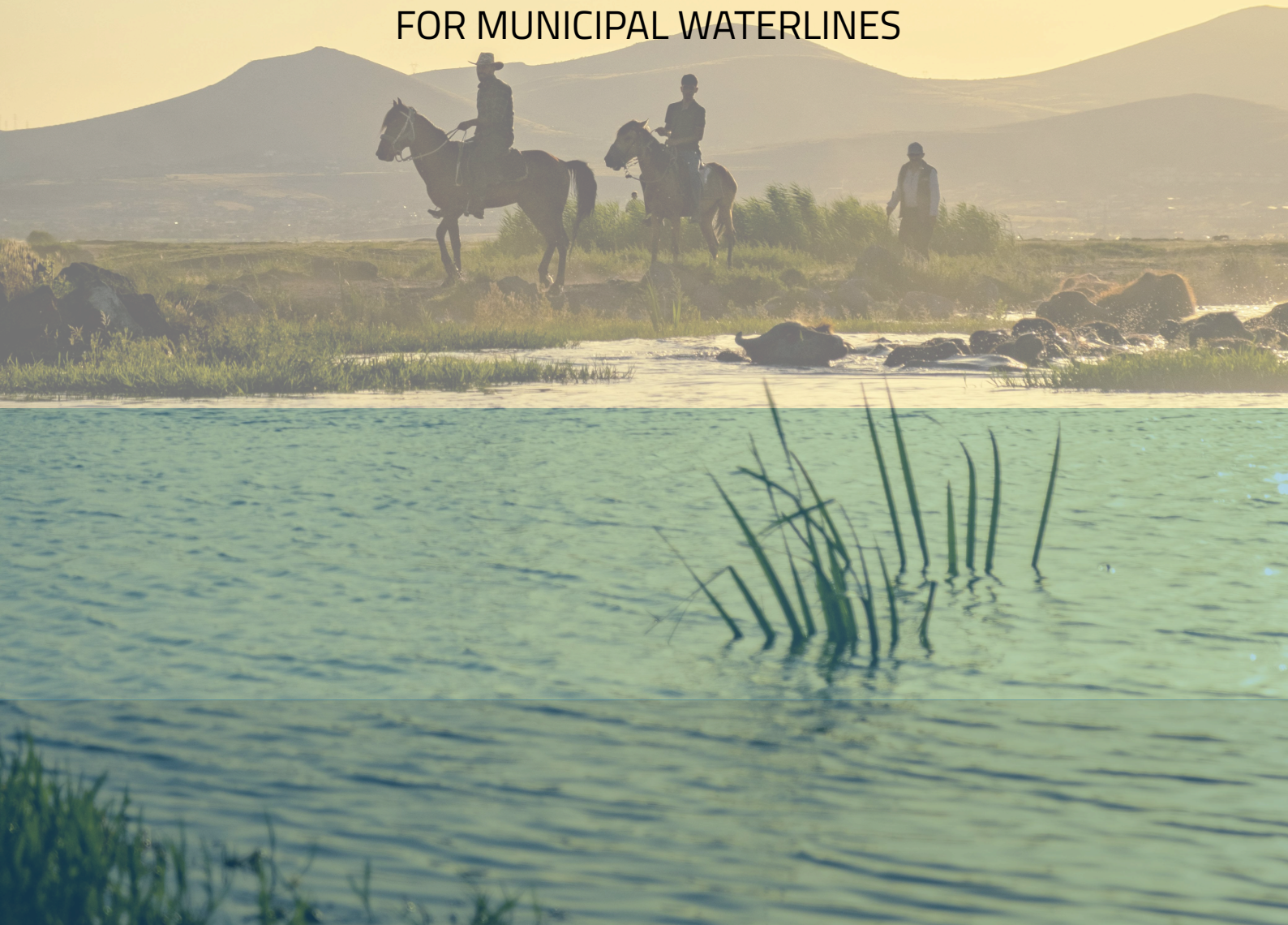

GATE VALVES

FOR MUNICIPAL WATERLINES



GATE VALVES

FOR MUNICIPAL WATERLINES



TVC resilient-seated gate valves. 2"–48". 250 PSI.

Our Story

TVC: Municipal Gate Valves, Built to Specification.

TVC manufactures and distributes resilient-seated gate valves for municipal waterlines across North America. Our product line spans 2"–48" in flanged and mechanical-joint configurations, rated to 250 PSI standard (200 and 300 PSI on request), and engineered to AWWA C515, NSF/ANSI 61, and applicable EPA requirements.

Product availability is structured in two tiers:

TVC Series I — globally sourced, available spring 2026. Full AWWA C515 compliance, fusion-bonded epoxy coating to AWWA C550, available in flanged and MJ end configurations.

TVC Series II — cast, machined, and assembled in the United States, available summer 2026. AIS (American Iron and Steel) compliant, meeting domestic-content requirements for federally funded municipal water projects. Same AWWA C515 specifications and NSF/ANSI 61 certifications as Series I.

Full submittals, test reports, and origin documentation available on request.



SPECIFICATION	
ITEM	DETAILS
Size	2" to 48"
Nominal Pressure	145 PSI / 250 PSI
Working Temperature	14°F to 250°F
Suitable Medium	Chemicals, air, water, steam, oil, acids, salts, etc.

STANDARD	
CATEGORY	STANDARD
Design Standard	DIN3352 F4/F5, MSS SP-70, AWWA C509/515, BS5163
Face to Face	DIN3202 F4/F5, BS5163, ANSI B16.10
Flange Drilling	DIN2533 145 PSI/250 PSI, ANSI 125/150, JIS10K
Test Inspection	DIN3230, BS6755
Design Standard	DIN3352 F4/F5, MSS SP-70, AWWA C509/515, BS5163

MATERIALS	
COMPONENT	MATERIAL
Body	Cast Iron, Ductile Iron
Wedge	Cast Iron, Ductile Iron
Stem	Stainless Steel, Brass
Sealing Ring	EPDM, NBR
O-Ring	EPDM, NBR



TVC resilient-seated gate valves. 2"–48". 250 PSI.

Our Story

Our products. From pressure testing to final coating, every TVC valve passes through a production process designed to AWWA C515 standards. Shown: Series II production imagery.



Gate Valves — General Spec Sheet

TVC Series I

AWWA C515 NRS Resilient Seated — Flanged Ends (International)

Specifications

Design complies with AWWA C515 Standard

Non-Rising stem, Resilient Seated

Flanges drilling to ANSI B16.1 Class 125

Flange thickness: AWWA C515.

(Other Flange Types available upon request)

Fusion Bonded Epoxy Coated Interior and Exterior to AWWA C550 Standard

Working Pressure: 250 PSI

(200 and 300 PSI available on request)

Working Temperature: -4°F to 185°F

Operator: Handwheel, 2" Operating Nut, Gearbox

GATE VALVE		
NO.	Part	Material (ASTM)
1	Body	Ductile Iron ASTM A536
2	Wedge	Ductile Iron EPDM
3	Wedge Nut	C37700
4	Stem	SS316
5	Bonnet Gasket	Rubber NBR
6	Bonnet	Ductile Iron ASTM A536
7	Gland	Ductile Iron ASTM A536
8	O-ring	Rubber NBR
9	Dust Cap	Rubber NBR
10	Handwheel	Ductile Iron ASTM A536
11	Bonnet Bolt	A4-70
12	Handwheel	A4-70

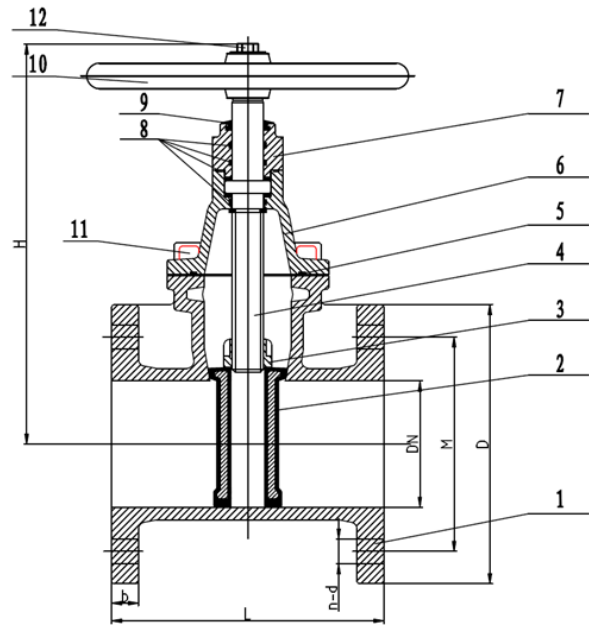

DIMENSION AWWA C515								
in	L	H	M	D	n-d	b	Switch Turns	Weight (lbs)
2"	7	9 5/8	4.75	6	4-3/4	5/8	7	23
2.5"	7 1/2	10 1/8	5.5	7	4-3/4	3/4	8.5	30
3"	8	10 7/8	6	7.5	4-3/4	3/4	10	40
4"	9	13 1/8	7.5	9	8-3/4	3/4	13	57
6"	10 1/2	17 7/8	9.5	11	8-7/8	3/4	18.5	97
8"	11 1/2	21	11.75	13.5	8-7/8	7/8	24.5	154
10"	13	25 3/8	14.25	16	12-1	1	30.5	220
12"	14	28 7/8	17	19	12-1	1	36.5	324
14"	15	35 3/4	18.75	21	12-1 1/8	1	45	575
16"	16	38	21.25	23.5	16-1 1/8	1	51.5	741
18"	17	41 5/8	22.75	25	16-1 1/4	1 1/8	58	886
20"	18	46 7/8	25	27.5	20-1 1/4	1 1/8	43	1155
24"	20	53 5/8	29.5	32	20-1 3/8	1 1/8	51.5	1552

Gate Valves — General Spec Sheet

TVC Series I

AWWA C515 NRS Resilient Seated — Mechanical Joints (International)

Specifications

Design Standard AWWA C515.

Non-Rising stem, Resilient Seated.

Face to Face: ASME B16.10.

MJ * MJ to AWWA C111/A21.11-12-153.

(FL * MJ available upon request)

Inspection & testing: AWWA C515.

Fusion Bonded Epoxy Coated Interior and Exterior to AWWA C550 Standard

Working Pressure: 250 PSI

(200 and 300 PSI available on request)

Working Temperature: -4°F to 185°F

Operator: Handwheel, 2" Operating Nut, Gearbox

GATE VALVE		
NO.	Part	Material (ASTM)
1	Body	Ductile Iron ASTM A536
2	Wedge	Ductile Iron EPDM
3	Wedge Nut	Brass C37700
4	Stem	SS304
5	Bonnet Gasket	Rubber NBR
6	Bonnet	Ductile Iron ASTM A536
7	Seal ring	Rubber NBR
8	Gland	Ductile Iron ASTM A536
9	Bolt	A2-70
10	O-ring	Rubber NBR
11	Dust Cap	Rubber NBR
12	Operating Nut	Ductile Iron ASTM A536
13	Gasket	Brass
14	Bonnet bolt	A2-70

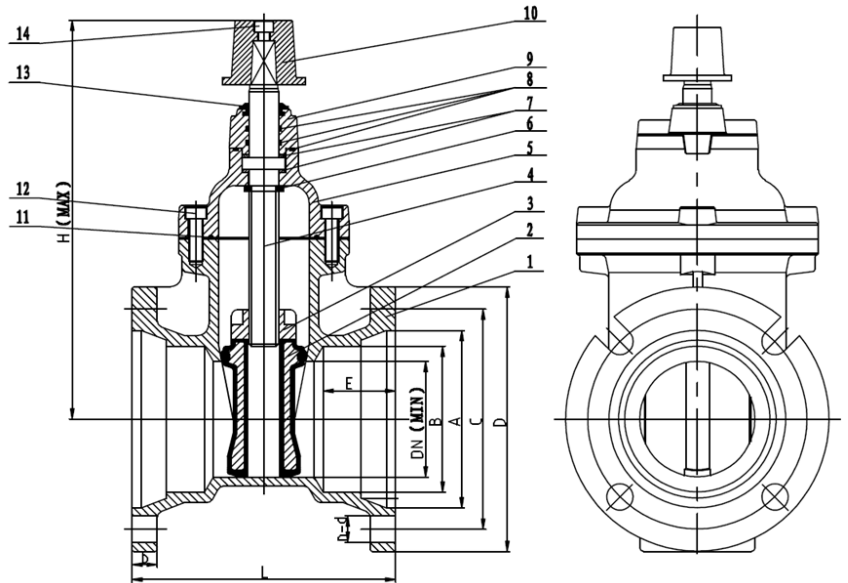

DIMENSIONS AWWA C515											
inch	L	H	C	D	b	n-d	A	E	B	Turns	Weight (lbs)
2"	8.25	10 3/8	4 3/4	6 1/4	5/8	2-3/4	3 1/2	2.5	2 5/8	7	22
3"	8	11 1/8	6 1/4	7 3/4	3/4	4-3/4	5	2.5	4 1/8	10	36
4"	9	13 7/8	7.5	9	3/4	4-7/8	6	2.5	4 7/8	13	53
6"	10.5	17 7/8	9 1/2	11 1/8	3/4	6-7/8	8 1/8	2.5	7	18.5	99
8"	11 1/2	22	11 3/4	13 3/8	3/4	6-7/8	10 1/4	2.5	9 1/8	24.5	134
10"	13	26 3/8	14	15 5/8	1	8-7/8	12 3/8	2.5	11 1/4	30.5	265
12"	14	29 5/8	16 1/4	17 7/8	1	8-7/8	14 1/2	2.5	13 1/4	36.5	351
14"	15	36 1/8	18.75	20 3/8	1	10-7/8	16 1/2	3.5	15 1/2	45	505
16"	16	38 3/8	21	22 5/8	1	12-7/8	18 5/8	3.5	17 1/2	51.5	609
18"	17	42	23 1/4	24 3/4	1	12-7/8	20 3/4	3.5	19 5/8	58	840
20"	18	47 1/4	25 1/2	27	1 1/8	14-7/8	22 7/8	3.5	21 3/4	43	1105
24"	20	53 5/8	30	31 5/8	1 1/8	16-7/8	27	3.5	25 7/8	51.5	1704

Gate Valves — General Spec Sheet

TVC Series II

AWWA C515 NRS Resilient Seated — Flanged Ends (US Version)

AIS COMPLIANT

Specifications

Design complies with AWWA C515 Standard

Non-Rising stem, Resilient Seated

Flanges drilling to ANSI B16.1 Class 125

Flange thickness: AWWA C515.

(Other Flange Types available upon request)

Fusion Bonded Epoxy Coated Interior and Exterior to AWWA C550 Standard

Working Pressure: 250 PSI

(200 and 300 PSI available on request)

Working Temperature: -4°F to 185°F

Operator: Handwheel, 2" Operating Nut, Gearbox

GATE VALVE		
NO.	Part	Material (ASTM)
1	Body	Ductile Iron ASTM A536
2	Wedge	Ductile Iron EPDM
3	Wedge Nut	Brass C37700
4	Stem	SS304
5	Bonnet Gasket	Rubber NBR
6	Bonnet	Ductile Iron ASTM A536
7	Seal ring	Rubber NBR
8	Gland	Ductile Iron ASTM A536
9	Bolt	A2-70
10	O-ring	Rubber NBR
11	Dust Cap	Rubber NBR
12	Operating Nut	Ductile Iron ASTM A536
13	Gasket	Brass
14	Bonnet bolt	A2-70

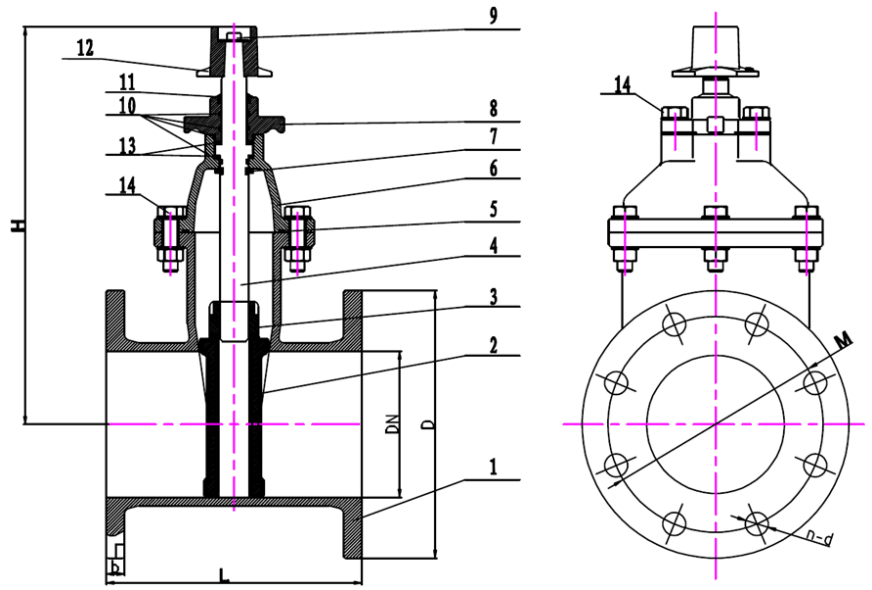

DIMENSIONS AWWA C515								
inch	L	H (MAX)	M	D	b	n-d	Turns	Weight (lbs)
2"	7	9 5/8	4 3/4	6	5/8	4-3/4	7	23
2.5"	7 1/2	10 1/8	5 1/2	7	3/4	4-3/4	8 1/2	30
3"	8	10 7/8	6	7.5	3/4	4-3/4	10	40
4"	9	13 3/4	7 1/2	9	3/4	8-3/4	13	57
6"	10 1/2	17 7/8	9 1/2	11	3/4	8-7/8	18.5	97
8"	11 1/2	22	11 3/4	13.5	7/8	8-7/8	24.5	154
10"	13	26 1/4	14 1/4	16	1	12-1	30.5	220
12"	14	29 5/8	17	19	1	12-1	36.5	324
14"	15	36 1/8	18 3/4	21	1	12-1 1/8	45	—
16"	16	38 3/8	21 1/4	23.5	1	16-1 1/8	51.5	—
18"	17	42	22 3/4	25	1 1/8	16-1 1/4	58	—
20"	18	47 1/4	25	27.5	1 1/8	20-1 1/4	43	—
24"	20	53 5/8	29 1/2	32	1 1/8	20-1 3/8	51.5	—

Gate Valves — General Spec Sheet

TVC Series II

AWWA C515 NRS Resilient Seated — Mechanical Joints (US Version)

AIS COMPLIANT

Specifications

Design Standard AWWA C515.

Non-Rising stem, Resilient Seated.

Face to Face: ASME B16.10.

MJ * MJ to AWWA C111/A21.11-12-153.

(FL * MJ available upon request)

Inspection & testing: AWWA C515.

Fusion Bonded Epoxy Coated Interior and Exterior to AWWA C550 Standard

Working Pressure: 250 PSI

(200 and 300 PSI available on request)

Working Temperature: -4°F to 185°F

Operator: Handwheel, 2" Operating Nut, Gearbox

GATE VALVE		
NO.	Part	Material (ASTM)
1	Body	Ductile Iron ASTM A536
2	Wedge	Ductile Iron EPDM
3	Wedge Nut	Brass C37700
4	Stem	SS304
5	Bonnet Gasket	Rubber NBR
6	Bonnet	Ductile Iron ASTM A536
7	Seal ring	Rubber NBR
8	Gland	Ductile Iron ASTM A536
9	Bolt	A2-70
10	O-ring	Rubber NBR
11	Dust Cap	Rubber NBR
12	Operating Nut	Ductile Iron ASTM A536
13	Gasket	Brass
14	Bonnet bolt	A2-70

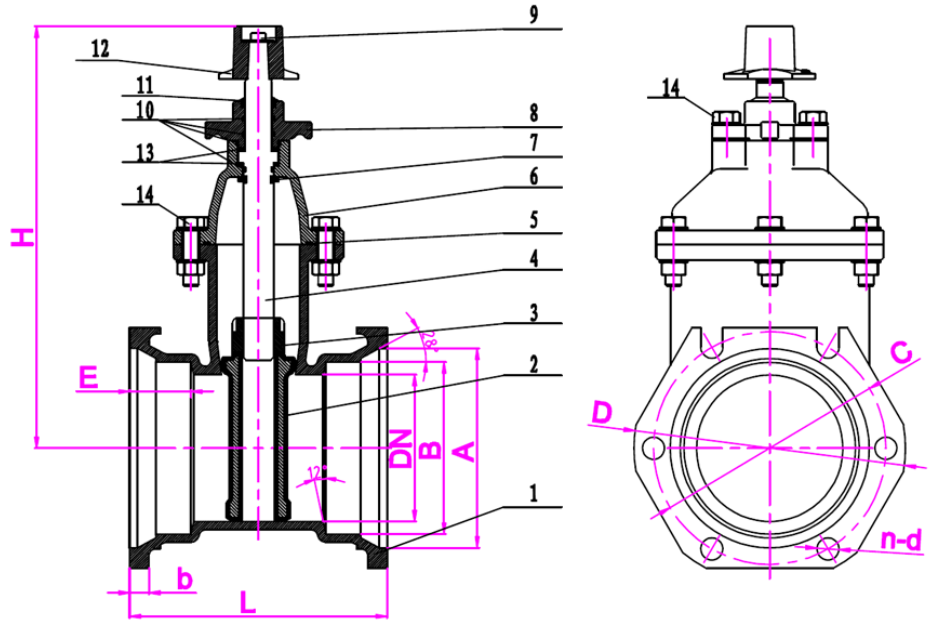

DIMENSIONS AWWA C515											
Inch	L	H (MAX)	C	D	b	n-d	B	A	E	TURNS	Weight (lbs)
2"	8 1/4	10 3/8	4 3/4	6 1/4	5/8	2-3/4	2 5/8	3 1/2	2 1/2	7	23
3"	8	11 1/8	6 1/4	7 3/4	3/4	4-3/4	4 1/8	5	2 1/2	10	39
4"	9	13 3/4	7 1/2	9 1/8	3/4	4-7/8	4 7/8	6	2 1/2	13	54
6"	10 1/2	17 7/8	9 1/2	11 1/8	3/4	6-7/8	7	8 1/8	2 1/2	18.5	80
8"	11 1/2	22	11 3/4	13 3/8	7/8	6-7/8	9 1/8	10 1/4	2 1/2	24.5	148
10"	13	26 1/4	14	15 5/8	1	8-7/8	11 1/4	12 3/8	2 1/2	30.5	224
12"	14	29 5/8	16 1/4	17 7/8	1	8-7/8	13 1/4	14 1/2	2 1/2	36.5	335
14"	15	36 1/8	18 3/4	20 3/8	1	10-7/8	15 1/2	16 1/2	3 1/2	45	—
16"	16	38 3/8	21	22 5/8	1	12-7/8	17 1/2	18 5/8	3 1/2	51.5	—
18"	17	42	23 1/4	24 3/4	1	12-7/8	19 5/8	20 3/4	3 1/2	58	—
20"	18	47 1/4	25 1/2	27	1 1/8	14-7/8	21 3/4	22 7/8	3 1/2	43	—
24"	20	53 5/8	30	31 5/8	1 1/8	16-7/8	25 7/8	27	3 1/2	51.5	—

Our Domestic Capability



Cast in America. Machined in America. Assembled in America.

TVC Series II is more than an "assembled in USA" story. Every Series II valve is cast, machined, and assembled in the United States — bringing the full manufacturing process home and meeting the domestic-content requirements that matter most to municipal buyers.

AIS compliant. Series II meets the American Iron and Steel requirements that apply to State Revolving Fund-backed drinking water and clean water projects.

BABA-ready. Series II is engineered to support Build America, Buy America Act compliance for federally funded municipal water infrastructure.

Full documentation. Every Series II order ships with origin, material, and compliance documentation ready for your project file.

CAST	MACHINED	ASSEMBLED
<p>Ductile iron bodies and components cast at US foundries to ASTM A536.</p>	<p>Precision machining performed stateside to AWWA C515 tolerances.</p>	<p>Final assembly, epoxy coating (AWWA C550), and hydrostatic testing in the United States.</p>

Quality Certifications



EPA (U.S. Environmental Protection Agency)

TVC gate valves meet EPA requirements applicable to products used in public drinking water systems. Our fusion-bonded epoxy interior coatings comply with the EPA's lead and contaminant standards for potable water contact surfaces.



NSF/ANSI 61

Every TVC valve carries NSF/ANSI 61 certification, the national standard for drinking water system components. This certification verifies that our valves will not leach contaminants into potable water — a non-negotiable baseline for municipal waterline service.



AWWA (American Water Works Association)

TVC resilient-seated gate valves are engineered to AWWA C515 for non-rising-stem gate valves and AWWA C550 for fusion-bonded epoxy coatings. Mechanical joint products comply with AWWA C111/A21.11. These are the standards municipal engineers specify by name.



AIS — American Iron and Steel (Series II)

TVC Series II valves comply with the American Iron and Steel (AIS) requirements that apply to State Revolving Fund-assisted drinking water and clean water projects. For any municipal project drawing on SRF funding, Series II is purpose-built to qualify.